

28003210

LC

Tridonic, LC 14W 250/350mA flexC R ADV2, LED Compac Fixed output Constant Current LED Driver , Made In PRC, 5yrs Warranty



DATA SHEET

LINE DRAWING

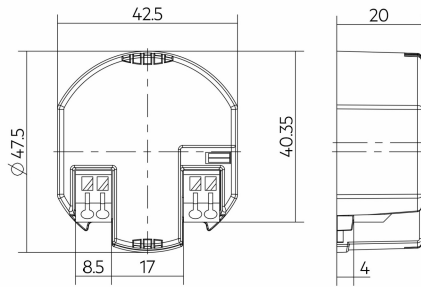

[Click to view the full product details](#)

MARKETING INFORMATION

Brief Description LC 14W 250-350mA flexC R ADV2 Constant Current LED Driver

PHYSICAL CHARACTERISTICS

Colour Finish White

MECHANICAL SPECIFICATION

Length (mm) 20mm  
Width (mm) 42.5mm  
Height (mm) 40.35mm

ELECTRICAL & SAFETY SPECIFICATION

Protection Class Class 2 - Double Insulated  
Dimmable No  
IP Rating IP20

QUALITY STANDARDS

Average Life (hrs) 50000hrs  
Warranty (yrs) 5yrs

Inspired Lighting Ltd. are continually developing and improving their products.  
Technical specifications subject to change without prior notice.