

87500796

LC

Tridonic, LC 10W 350mA fixC C SNC2, LED Converter Compact SNC - ESSENCE, Made In PRC, 5yrs Warranty

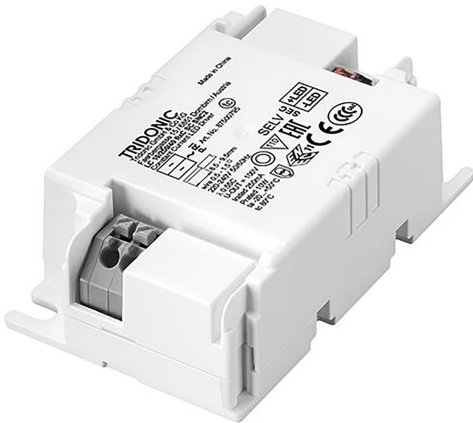

LINE DRAWING

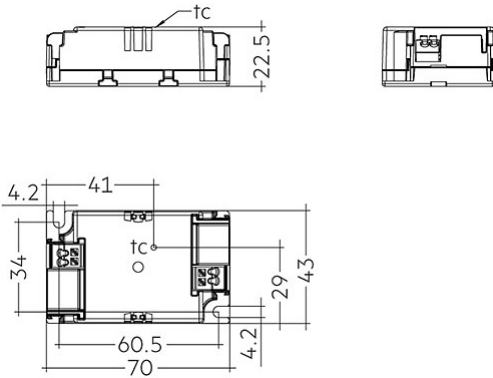

DATA SHEET

MARKETING INFORMATION

Brief Description	10W 350mA fixC C SNC2 ESSENCE Constant Current LED Driver
-------------------	--

PHYSICAL CHARACTERISTICS

Colour Finish	White
---------------	-------

MECHANICAL SPECIFICATION

Item Nett Weight (kg)	0.39kg
Length (mm)	70mm
Width (mm)	43mm
Height (mm)	22.5mm

ENERGY SPECIFICATION

Energy Class	A++ to A
--------------	----------

ELECTRICAL & SAFETY SPECIFICATION

Protection Class	Class 2 - Double Insulated
Dimmable	No
IP Rating	IP20

QUALITY STANDARDS

Average Life (hrs)	50000hrs
Warranty (yrs)	5yrs

[Click to view the full product details](#)

OVERVIEW

Constant current Fixed output LED Driver, Independent LED Driver with cable clamps, For luminaires of protection class II, Temperature protection as per EN 61347-2-13 C5e. Long life and high efficiency.

Inspired Lighting Ltd. are continually developing and improving their products.  
Technical specifications subject to change without prior notice.