

# SN-15-250-G1N

# On/Off Constant Current

Intelligent Constant Current LED Driver, ON/OFF, 15W-200mA ,9-42Vdc , 200-240Vac, Out put Range.1.8W-8.4W, IP20, 5yrs Warrenty.



## DATA SHEET

### ELECTRICAL & SAFETY SPECIFICATION

Dimmer Included	No
IP Rating	IP20

### SENSOR SPECIFICATION

Working Humidity (%RH)	20~95%RH
------------------------	----------

### QUALITY STANDARDS

Average Life (hrs)	50000hrs
Warranty (yrs)	5yrs

## LINE DRAWING

Dimensions Unit : mm

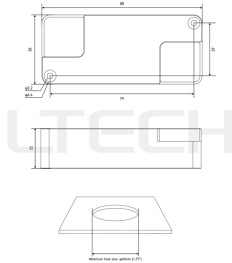

[Click to view the full product details](#)

## OVERVIEW

The housing is made from V0 flame retardant PC materials,Ultra-small, thin and light screwless end cap,Innovative thermal management technology intelligently protects the life of the LED driver.

Inspired Lighting Ltd. are continually developing and improving their products. Technical specifications subject to change without prior notice.